

LONGITUDINAL ABUTMENTS

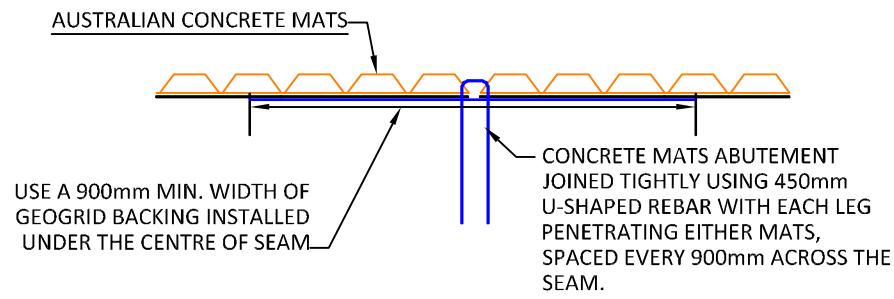

TRAVERSE OVERLAPS

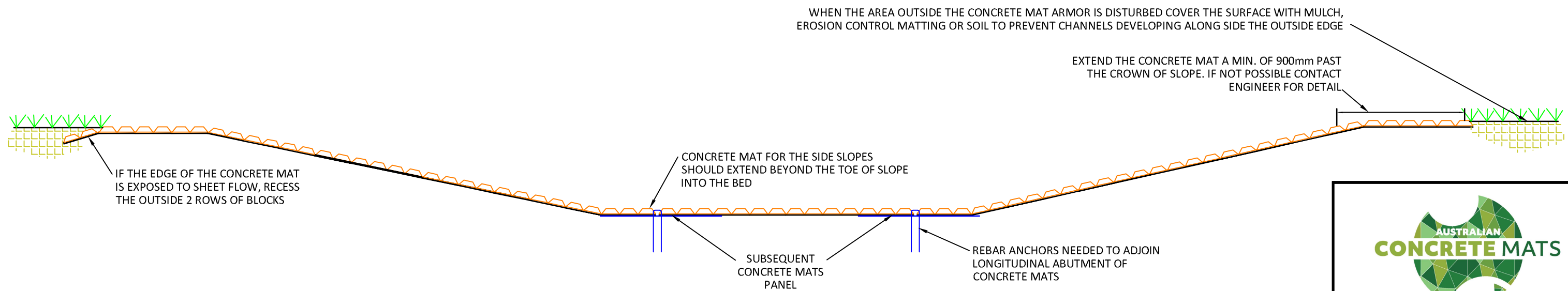
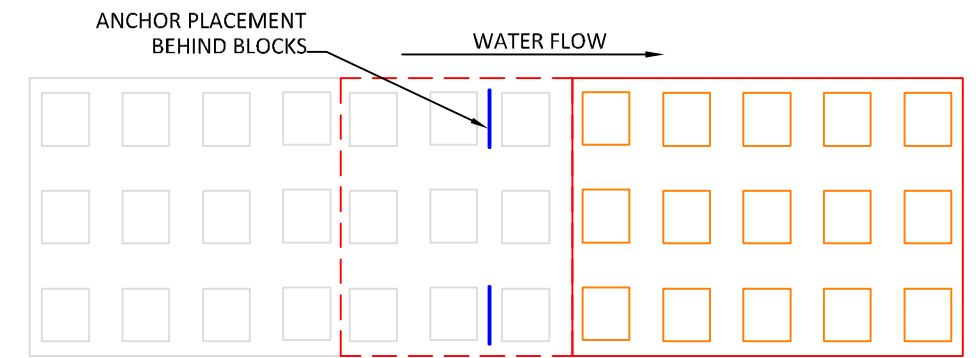
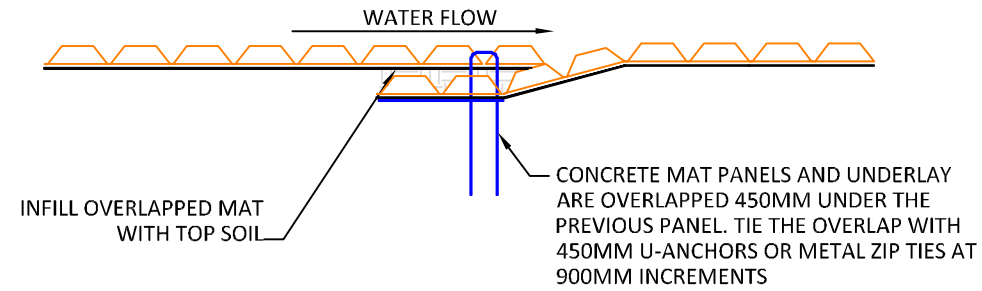

CONSTRUCTION NOTES:

1. AN ENGINEER MUST DESIGN AND/OR SIGN OFF ON THE DESIGN AND ONSITE INSTALLATION.
2. GRADE THE SITES SO THAT WATER WILL NOT FLOW ABOVE, BELOW, OR AROUND THE OUTSIDE OF THE AREA PROTECTED WITH AUSTRALIAN CONCRETE MATS. ALL SUBGRADE SURFACES PREPARED FOR PLACEMENT OF MATS SHALL BE SMOOTH AND FREE OF ALL ROCKS, STICKS, ROOTS, OTHER PROTRUSIONS, OR DEBRIS OF ANY KIND.
3. APPLY SITE SPECIFIC SEED, INCLUDING NATIVE GRASSES DIRECTLY TO THE PREPARED SOIL PRIOR TO AUSTRALIAN CONCRETE MAT INSTALLATION.
4. AUSTRALIAN CONCRETE MAT ROLLS ARE AVAILABLE IN WIDTHS OF 2400mm WIDE.
 - (a) TO ACHIEVE WIDER WIDTHS, INSTALL CONCRETE MATS ADJACENT TO ONE ANOTHER. INSTALL ADDITIONAL UNDERLAYMENT GEOGRID UNDER ALL ADJOINING MATS. A MINIMUM OF 450mm OF UNDERLAYMENT SHALL EXTEND UNDER EACH SIDE OF THE MAT AND DIRECTLY AGAINST THE SUBGRADE.
 - (b) INSTALL 450mm REBAR U-ANCHORS OR STAINLESS-STEEL ZIP TIES IN 900mm INCREMENTS THE LENGTH OF THE LONGITUDINAL SEAM. (OR AS DESIGNED BY AN ENGINEER FOR THE CONDITIONS)
5. AT THE BEGINNING OF THE AUSTRALIAN CONCRETE MATS, TRANSITION THE INITIAL LEADING EDGE PROPERLY WITH EROSION MATTING OR SOD. IF EXPOSED TO CONCENTRATED FLOWS EMBED 450mm VERTICALLY INTO THE SUB GRADE TO SERVE AS AN ANCHOR TRENCH. THE TRENCH SHALL BE FILLED AND COMPACTED WITH SUITABLE FILL OR OTHER (AS SPECIFIED BY EOR).
6. FOR ADDITIONAL SECTIONS OF MAT, OVERLAP THE DOWNSTREAM SECTION 450mm WITH UPSTREAM SECTION OF MAT. PRIOR TO INSTALLING OVERLAP, FLIP UPSTREAM MAT BACK 600mm. EXCAVATE 60mm OF SOIL 450mm FROM END OF UPSTREAM MAT. DOWNSTREAM SECTION IS LAID IN THE SHALLOW TRENCH. LIGHTLY SPREAD TOPSOIL, SEED AND FERTILIZER OVER INITIAL EDGE. FLIP END OF UPSTREAM MAT OVER THE SOIL COVERED INITIAL LEADING EDGE OF DOWNSTREAM MAT.
7. INSTALL 450mm U-ANCHORS IN 900mm INCREMENTS ACROSS THE OVERLAP. INSTALL ANCHORS DIRECTLY BEHIND BLOCKS. "U" ANCHORS CONSIST OF 10mm REBAR "U" ANCHOR WITH 450mm LEGS.
8. AT THE END OF THE ARMORED CHANNEL, EMBED THE MAT 450mm IN A TERMINATION TRENCH. FILL AND COMPACT TERMINATION TRENCH WITH SOIL (DETERMINED BY ENGINEER).



www.ConcreteMats.com.au

PO Box 94 Alstonville
NSW 2477, Australia
0414 280 009
info@concretemats.com.au

Project Title:
WIDE WATER CHANNEL DETAIL

Sheet Title:
INSTALLATION OF AUSTRALIAN CONCRETE MATS

THIS DESIGN AND/OR DRAWING ARE COPYRIGHT BEING THE PROPERTY OF AUSTRALIAN CONCRETE MATS AND SHALL NOT BE COPIED IN FULL OR IN PART NOR LENT OR REPRODUCED WITHOUT WRITTEN AUTHORIZATION FROM AUSTRALIAN CONCRETE MATS.

Paper: A3	Scale: NTS	Date: 2021/03/08
Drawn: BIS	Sheet:	
Checked: SM	J4	

GUIDES TO DESIGN, USAGE, ANCHORING AND INSTALLATION OF CONCRETE MATS.

PLEASE NOTE THAT AUSTRALIAN CONCRETE MATS (ACM) TECHNICAL DRAWINGS, ILLUSTRATIONS, NOTES AND ANCHORING DETAILS ARE TO BE USED AS A GUIDE ONLY. EVERY SOIL CONDITION, WATER FLOW RATE AND PROJECT HAVE VARYING PARAMETERS. ACM RECOMMEND THE USE AND ANCHORING DETAILS BE DESIGNED SPECIFICALLY BY A QUALIFIED AND CERTIFIED ENGINEER WHO IS FAMILIAR WITH YOUR SITE AND PROJECT CONDITIONS.